



**DENTAL**

Metal **DryLyte** Electropolishing

# DLyte 10D<sup>®</sup>



**DLyte 10D<sup>®</sup>** new patented machine for grinding and polishing steel and stainless-steel (chrome cobalt alloys for dental industry). Available for all types of dental skeletal, spacers, implants and orthodontics brackets. Capacity of **3 pieces** for each working cycle with an average of 50-60 minutes time cycle.

Machine patented and manufactured by

**GPAINNOVA**



The use of Patented DryLyte Technology is a concession approved by DryLyte Company

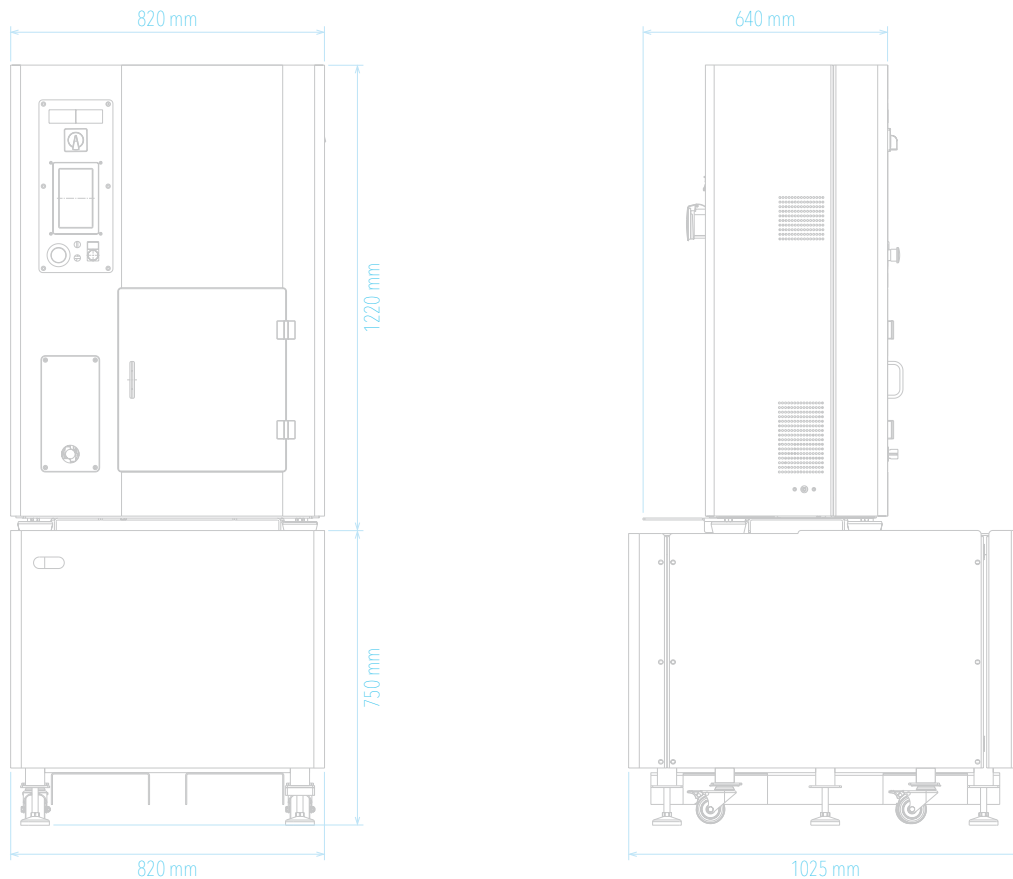

MODEL	<b>DLYTE 10D</b>
CAPACITY	3 pieces
MACHINE DIMENSIONS	820 x 640 x 1220 mm
SUPPORT DIMENSIONS	820 x 1025 x 750 mm
MACHINE WHEIGHT	205 kg (230 V) - 230 kg (110 V)
SUPPORT WHEIGHT	80 kg
POWER	3 kW
VOLTAGE	220-240 V or 110-115 V
AIR PRESSURE	4-5 bar

Consumption of 40 l/min. Quality air according ISO 8573 must be 1.5.1\*.  
 (\*) Air quality required for maintenance (Change filters) every 6 months.

## Consumables and Accessories



**ELECTROLYTE DLYTE-01 FOR 10D**



**ELECTROLYTE DLYTE-02 FOR 10D**



**HOLDER 10D**

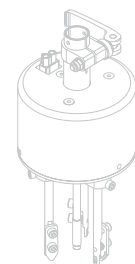

**VIBRATION HOLDER 10D**